

# U C V D



## Ultra Clean Vacuum Device



1

After removing the sampling port cap, clean the area clear of any contamination with an appropriate cloth.



2

Insert the plastic tubing into the sampling port so that the end of the tube reaches a midpoint within the oil.\*



3

Remove the safety cap from the UCVD.



6

With high viscosities, oil sampling could take a couple minutes to draw. You can leave the bottle sitting in any position, even upside down.

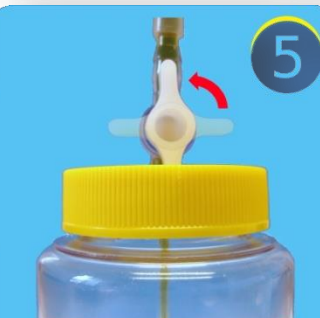

5

After the tube is in place, simply turn the valve on the UCVD 90° to allow the vacuum to draw the oil sample into the bottle.



4

Connect the other end of the plastic tubing to the nozzle at the top of the UCVD.

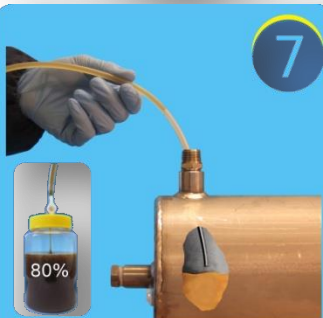

7

As the oil reaches 80% capacity, pull the tubing from the oil in the sampling port and allow the remaining oil in the tube to be drawn into the bottle.

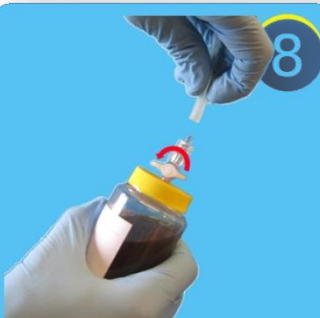

8

Once the UCVD has cleared the remaining oil in the tubing, close the valve by turning it 90° and then remove the tube.



9

Reattach the safety cap onto the UCVD.

Oil Sampling...

Made Easier.

\*Ensure that the end of the tube is dipped in the oil.

Rimuovere il cappuccio  
senza applicare flessione  
*Remove hood without  
bending*

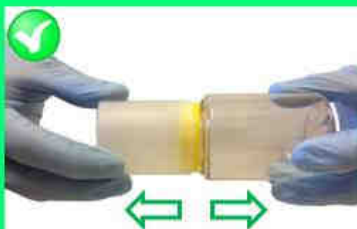

Collegare il tubo tenendo  
saldamente la valvola  
*Connect tubing firmly  
holding the valve*



Aprire il rubinetto tenendo  
saldamente il corpo valvola  
*Open valve holding the  
valve assembly*



## Safety Sampling



Warning! Be careful during sampling operation, many risks may occur due to operating oil/machine conditions.



Always sample in safety conditions by using Personal Protective Equipment (PPE) and be careful to remove oil spills from the floor potentially dangerous for people and environment.